



REMINGTON & VERNICK ENGINEERS
 2059 SPRINGDALE ROAD
 CHERRY HILL, NJ 08003
 (856) 795-9595, FAX (856) 795-1882
 WEB ADDRESS : RVE.COM
 Certification of Authorization: 24 GA 28003300
Excellence • Innovation • Service

DATE:
KENNETH C. RESSLER
 NJ PROFESSIONAL ENGINEER LIC. No. 34559

PLANS WHICH DO NOT BEAR AN EMBOSSED SEAL ARE NOT VALID

ALL DOCUMENTS PREPARED BY REMINGTON & VERNICK ENGINEERS AND AFFILIATES ARE INSTRUMENTS OF SERVICE IN RESPECT OF THE PROJECT. THEY ARE NOT INTENDED OR REPRESENTED TO BE SUITABLE FOR REUSE BY OWNER OR OTHERS ON EXTENSIONS OF THE PROJECT OR ON ANY OTHER PROJECT. ANY REUSE WITHOUT WRITTEN VERIFICATION OR ADAPTATION BY REMINGTON & VERNICK ENGINEERS AND AFFILIATES FOR THE SPECIFIC PURPOSE INTENDED WILL BE AT OWNERS SOLE RISK AND WITHOUT LIABILITY OR LEGAL EXPOSURE TO REMINGTON & VERNICK ENGINEERS AND AFFILIATES. AND OWNER SHALL INDEMNIFY AND HOLD HARMLESS REMINGTON & VERNICK ENGINEERS AND AFFILIATES FROM ALL CLAIMS, DAMAGES, LOSSES AND EXPENSES ARISING OUT OF OR RESULTING THEREFROM.

NO.	REVISION	DATE	BY

PROPOSED FLOOR PLAN

EVESHAM TOWNSHIP
 INDIAN SPRING COUNTRY CLUB
 BALCONY
 BURLINGTON COUNTY
 NEW JERSEY

DRAWN BY:	DESIGN BY:	CHECKED BY:	SCALE:
JG	MK	MB	AS NOTED
DATE:	SHEET No.:		
03.2023	S-2		
JOB No.:	0313-T-238		

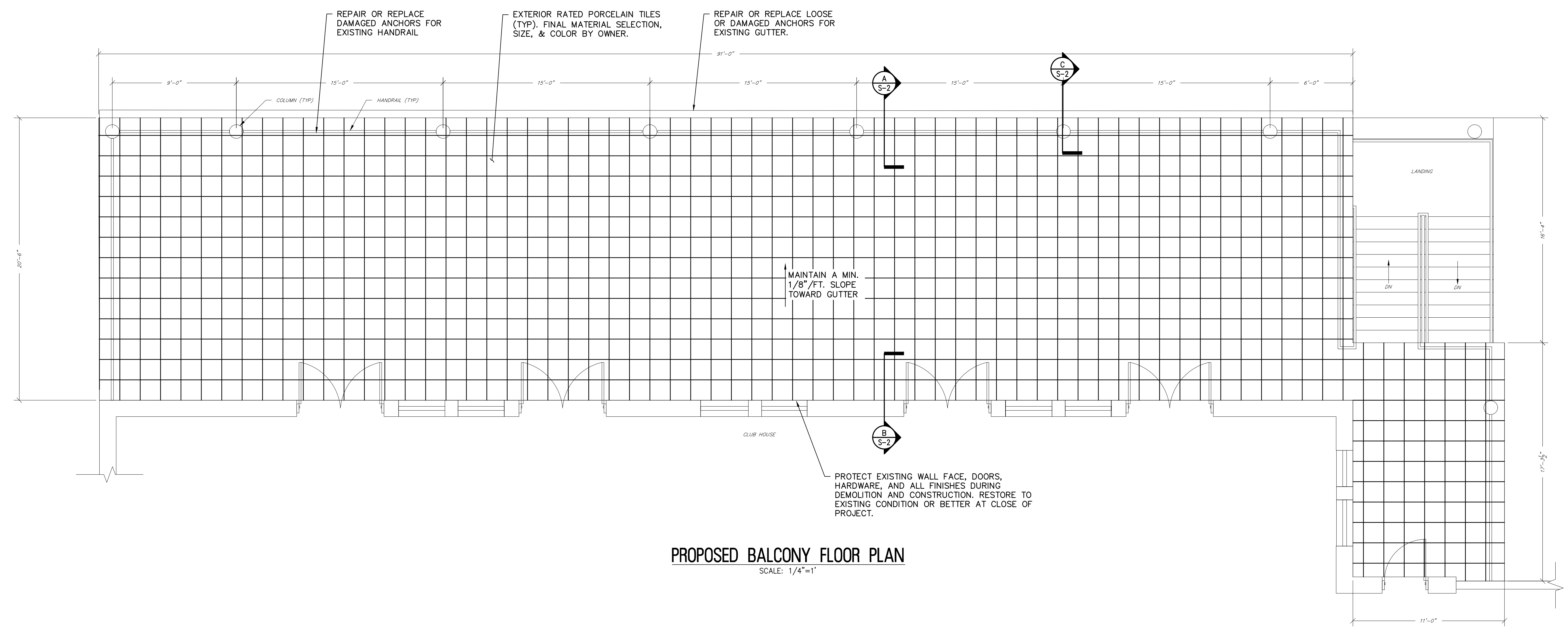

PROPOSED BALCONY FLOOR PLAN
 SCALE: 1/4"=1'

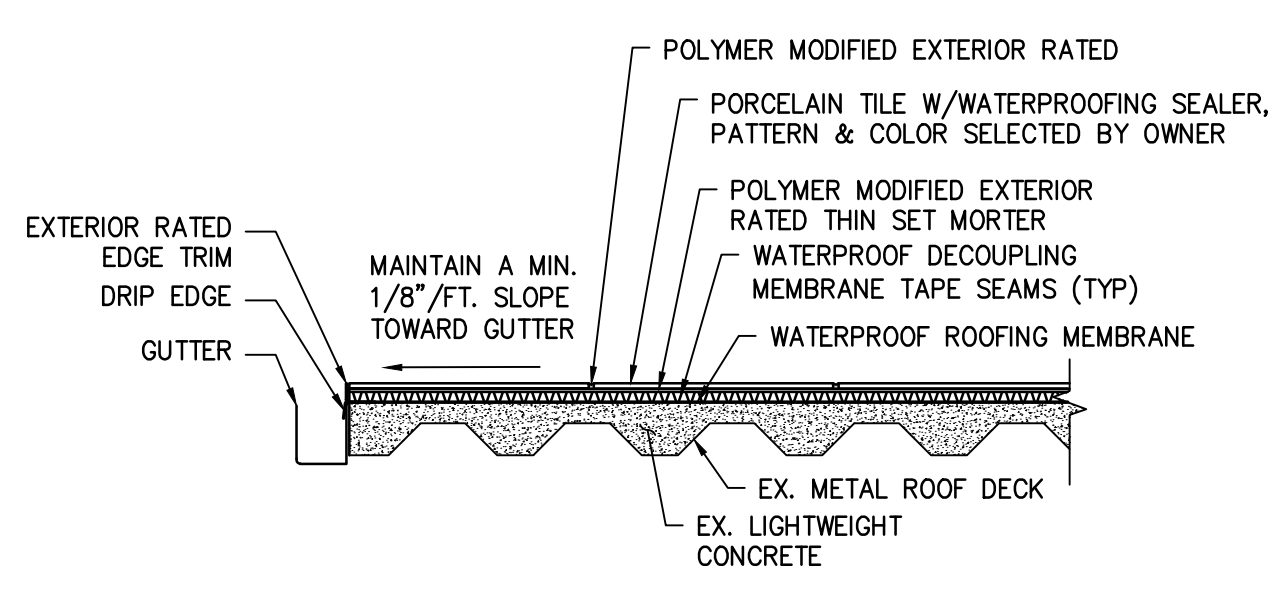

A
 S-2
PROP. FLOOR CROSS SECTION
 N.T.S.

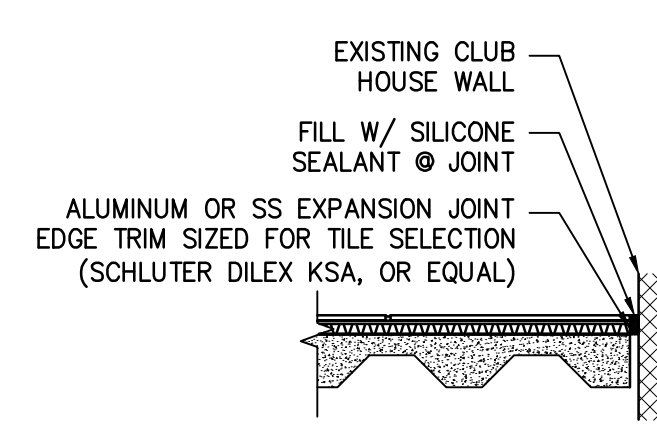

B
 S-2
PROP. FLOOR CROSS SECTION
 N.T.S.

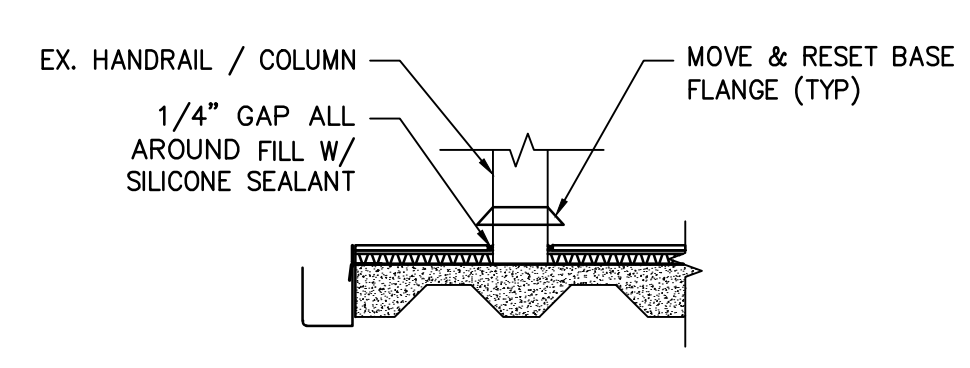

C
 S-2
PROP. FLOOR CROSS SECTION
 N.T.S.

