



REMINGTON & VERNICK ENGINEERS
 2059 SPRINGDALE ROAD
 CHERRY HILL, NJ 08003
 (856) 795-9595, FAX (856) 795-1882
 WEB ADDRESS : RVE.COM
 Certification of Authorization: 24 GA 28003300
 Excellence • Innovation • Service



NETTA ARCHITECTS
 NEW JERSEY | FLORIDA | NEW YORK
 CERTIFICATE OF AUTHORIZATION AC-438

NICHOLAS J. NETTA, AIA, NCARB
 NY License No. AI 12541

These drawings, or parts thereof, may not be reproduced in any form, by any method, for any purpose, without the prior written consent from:
NETTA ARCHITECTURE LLC

These drawings shall be used for the specific project location indicated within the Title Block, and shall not be used at any other location without prior consent from the ARCHITECT.

PLANS WHICH DO NOT BEAR AN EMBOSSED SEAL ARE NOT VALID

ALL DOCUMENTS PREPARED BY REMINGTON & VERNICK ENGINEERS AND AFFILIATES ARE INSTRUMENTS OF SERVICE IN RESPECT OF THE PROJECT. THEY ARE NOT INTENDED OR REPRESENTED TO BE SUITABLE FOR REUSE BY OWNER OR OTHERS ON EXTENSIONS OF THE PROJECT OR ON ANY OTHER PROJECT. ANY REUSE WITHOUT WRITTEN VERIFICATION OR ADAPTATION BY REMINGTON & VERNICK ENGINEERS AND AFFILIATES FOR THE SPECIFIC PURPOSE INTENDED WILL BE AT OWNERS SOLE RISK AND WITHOUT LIABILITY OR LEGAL EXPOSURE TO REMINGTON & VERNICK ENGINEERS AND AFFILIATES. AND OWNER SHALL INDEMNIFY AND HOLD HARMLESS REMINGTON & VERNICK ENGINEERS AND AFFILIATES FROM ALL CLAIMS, DAMAGES, LOSSES AND EXPENSES ARISING OUT OF OR RESULTING THEREFROM.

NO.	DATE	BY	CHK	REVISION
1	11.25.2025	BT	LU	ALTERNATE BID CONFORMED SET
2				
3				
4				
5				
6				
7				
8				
9				
10				
11				
12				
13				
14				
15				
16				
17				
18				
19				
20				
21				
22				
23				
24				
25				
26				
27				
28				
29				
30				
31				
32				
33				
34				
35				
36				
37				
38				
39				
40				
41				
42				
43				
44				
45				
46				
47				
48				
49				
50				

CONSTRUCTION PLAN ALTERNATE BID
 EVESHAM TOWNSHIP
 INDIAN SPRING DRIVING RANGE
 CLUBHOUSE IMPROVEMENTS
 115 SOUTH ELMWOOD ROAD MARLTON, NEW JERSEY 08053
 EVESHAM TOWNSHIP BURLINGTON COUNTY NEW JERSEY

DRAWN BY	DESIGN BY	CHECKED BY	SCALE
BT		LU	AS NOTED
DATE			
01.2023			
JOB No.			
0313-T-227			
SHEET No.	A-101A		

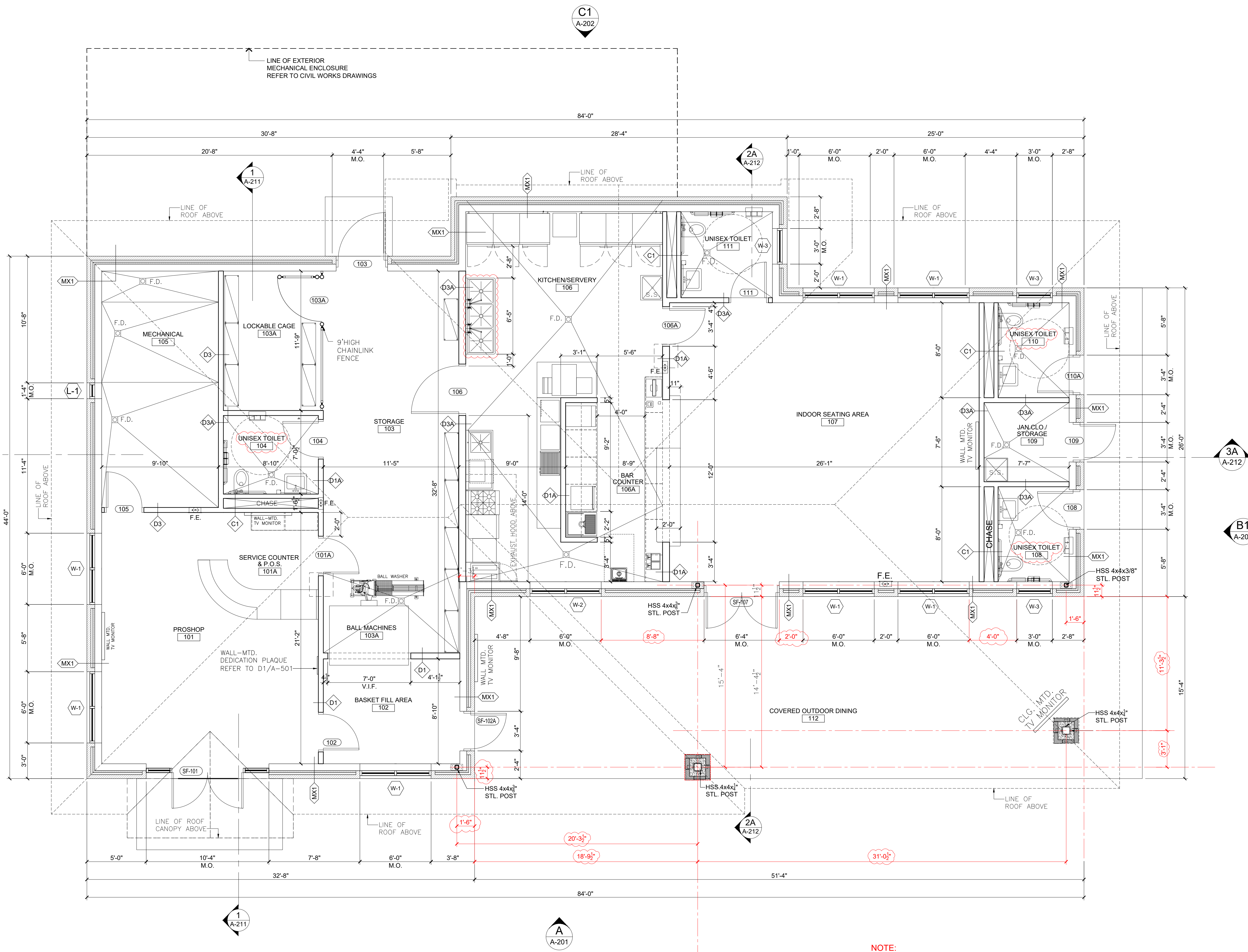

1 CONSTRUCTION PLAN - ALTERNATE BID
 SCALE: 1/4" = 1' - 0"

NOTE:
 THE BUBBLED DIMENSIONS SHOWN HEREIN REFLECTS THE REVISIONS ON SUBMITTAL #15 (STEEL FRAME OUTDOOR DINING).
ISSUED FOR DIMENSIONAL CLARIFICATIONS ONLY
11.25.2025